

Exterior Pro 2.3 Surface

Range of Decors / Release April 2023



For you to create



Fundermax



Contents

Sustainability and the Environment	4
Exterior Pro 2.3 Surface Collection	6
Decor overview and delivery programme	26
Products	30
Fundermax Individual Solutions	36
Essential Collection	40
Other Pro Collections	42

Fundermax

No matter whether it's furniture, facades, or interior design: where ideas and materials meet, you'll find Fundermax. As a global market leader in the field of compact panels and a manufacturer of high-quality wood-based materials and laminates, the company is proud to look back on a history spanning 130 years. The continued success is based on the highest quality, innovative and varied design, and sustainable production. Made in Austria—with great love for wood as a natural material, creations, and imagination.

- modern production facilities in Austria and Norway
- around 1,400 employees
- annual sales of €430 million
- part of Constantia Industries AG
- The Austrian Excellence Award (2018)



1 Sustainability and the Environment

Offering high-quality wood based compact, and HPL panels with various decors, Fundermax positions itself at the very heart of the architecture of a building. We design and manufacture a broad spectrum of products made from natural materials that are easy to work with, in order to provide architects, designers, facade designers, interior designers, and industrial companies with solutions that stand the test of time.

Fundermax has been processing natural materials with precision and love for 130 years. Today, we are manufacturers of high-quality timber composite materials and a global leader in compact laminates for both internal and external applications. Fundermax stands for nothing less than top quality and excellent design.

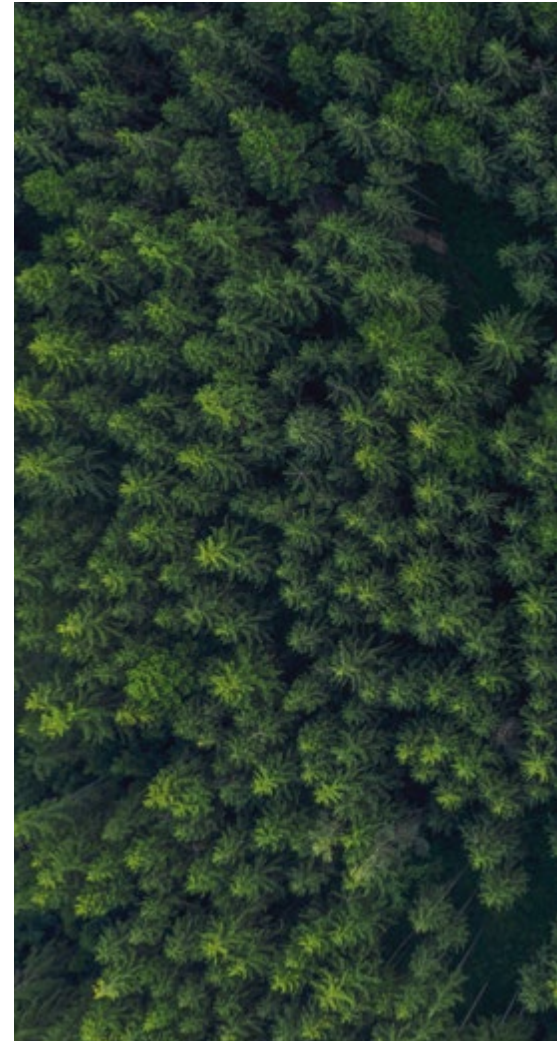



100% wood and paper



comes from sustainable and certified forestry management.

10,000 t CO₂



saved every year

100% green electricity

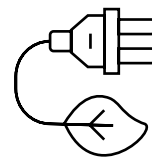

generated during production.

This and much more is what makes Fundermax a sustainable company, always looking to the future.

Find out more in our Sustainability Brochure via this QR code.



Sustainability Brochure

2 Exterior Pro 2.3 | Surface Collection

Fundermax Exterior is synonymous with product quality, sustainability, innovation, and design freedom. We developed the overarching new Exterior 2.3 collection in collaboration with international architects and our experienced teams. In order to accommodate your project requirements, we divided it into two subcollections. In the Essential collection, the focus is on maximum choice of decorative finishes and efficiency. In the Pro Surface collection, it's all about design using surface textures and visual effects. For maximum design freedom, there's Fundermax Individual. Create your very own design using Fundermax custom printing or add accents by machining a design directly onto the material surface without the need for further processing. Whatever form your idea takes, the Exterior 2.3 collection from Fundermax opens up a whole world of design possibilities.

For you to create.

Exterior Pro 2.3 Surface

Unique surfaces combined with a variety of decors—they could be the perfect option for your very special project!

All of the decors in this collection can be supplied with the NG, NP, and NY surfaces in this size:

- 4,100 x 1,300 mm = 5.33 m²

For details, see the product portfolio on page 28.

NG Gloss

Combined with solid colours, the impact of NG Gloss is bold and expressive, while with wood and other material effects, it is exclusive and elegant. The surroundings are incorporated into the design through the high reflectivity of the surface, adding to its appeal.



NP Paragon

This matte surface with anti-finger print technology is calming and self-assured. This is highlighted by the pleasant and high-value feel of NP Paragon.



NY Sky

Convincing depth effect and pleasant feel—this texture is spirited, raw, and natural, and complements the range of surfaces perfectly.



Colour

Architecture means providing perspectives and having a powerful influence on public perception.

In our Exterior Pro 2.3 | Surface range, you'll find a selection of decors that the Gloss, Sky, and Paragon surfaces show in their best light.

For you to create.



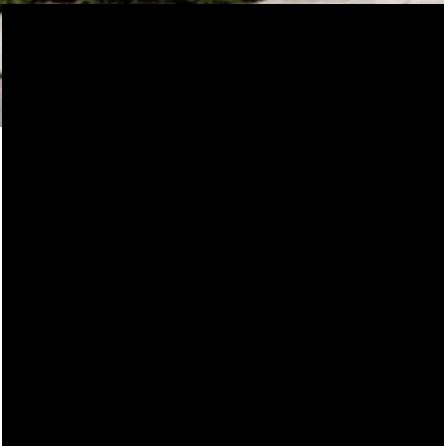

0080 Black

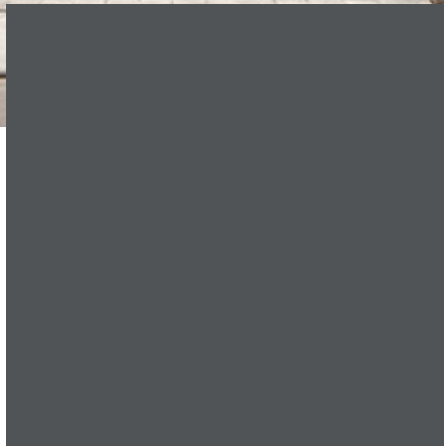

0070 Carbon Grey



0077 Charcoal



0900 Dark Cyber Grey



0075 Dark Grey

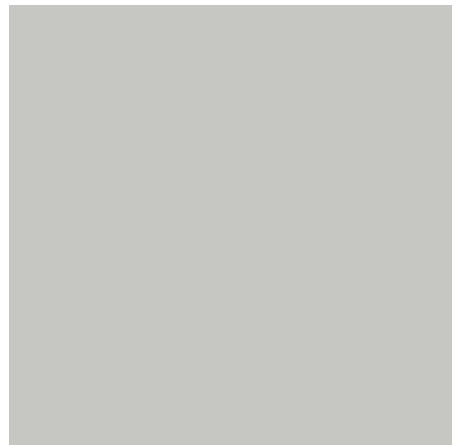

0074 Pastel Grey

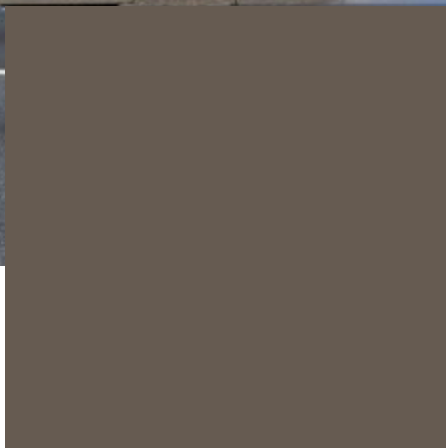
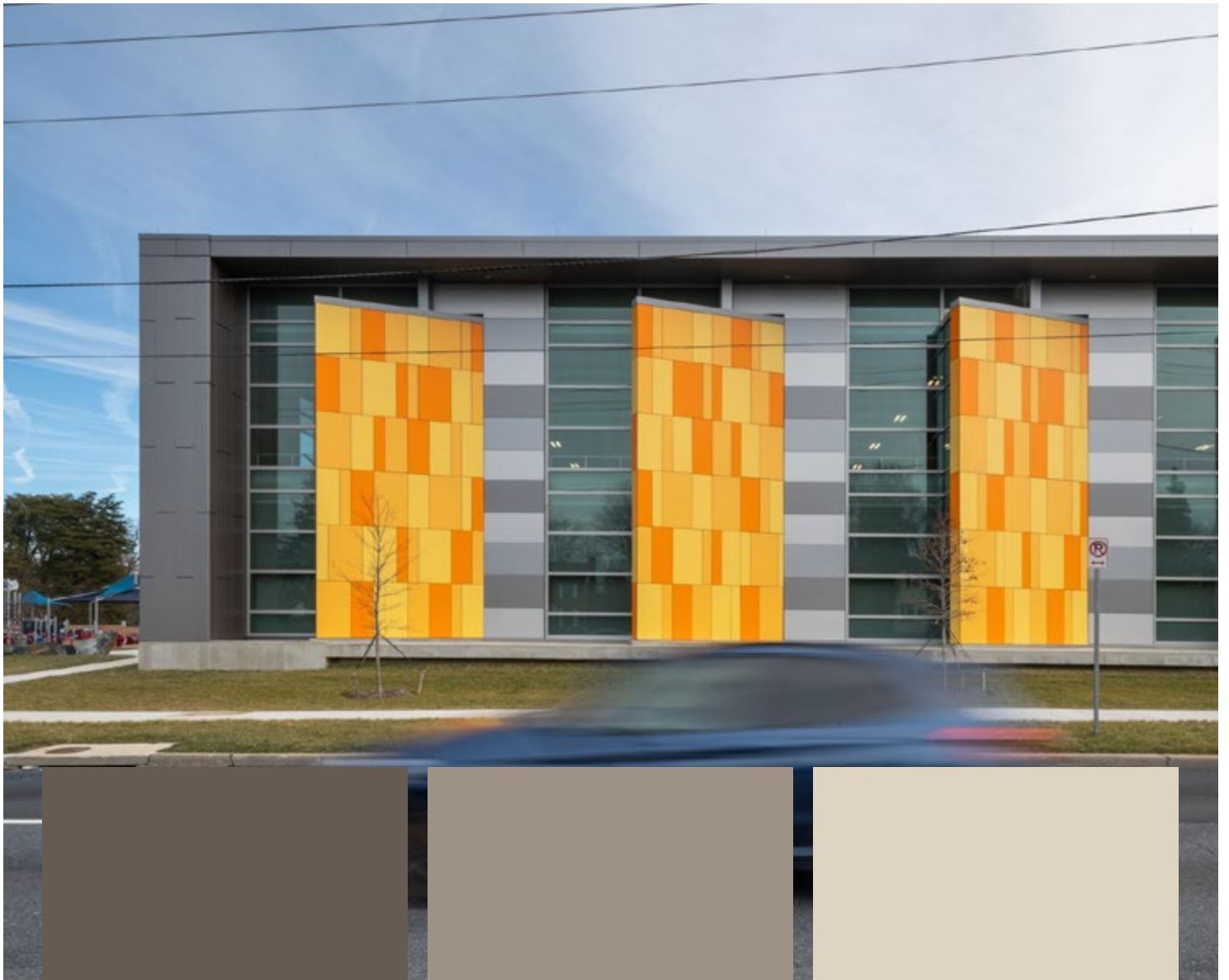

0887 Dark Offroad Greige

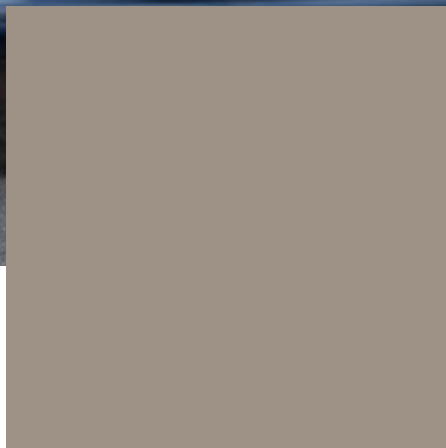

2206 Fango

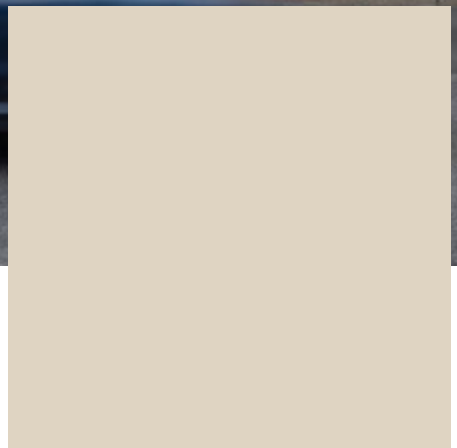

2289 Tortora



0874 Maroon



0873 Red Pepper



0864 Mustard

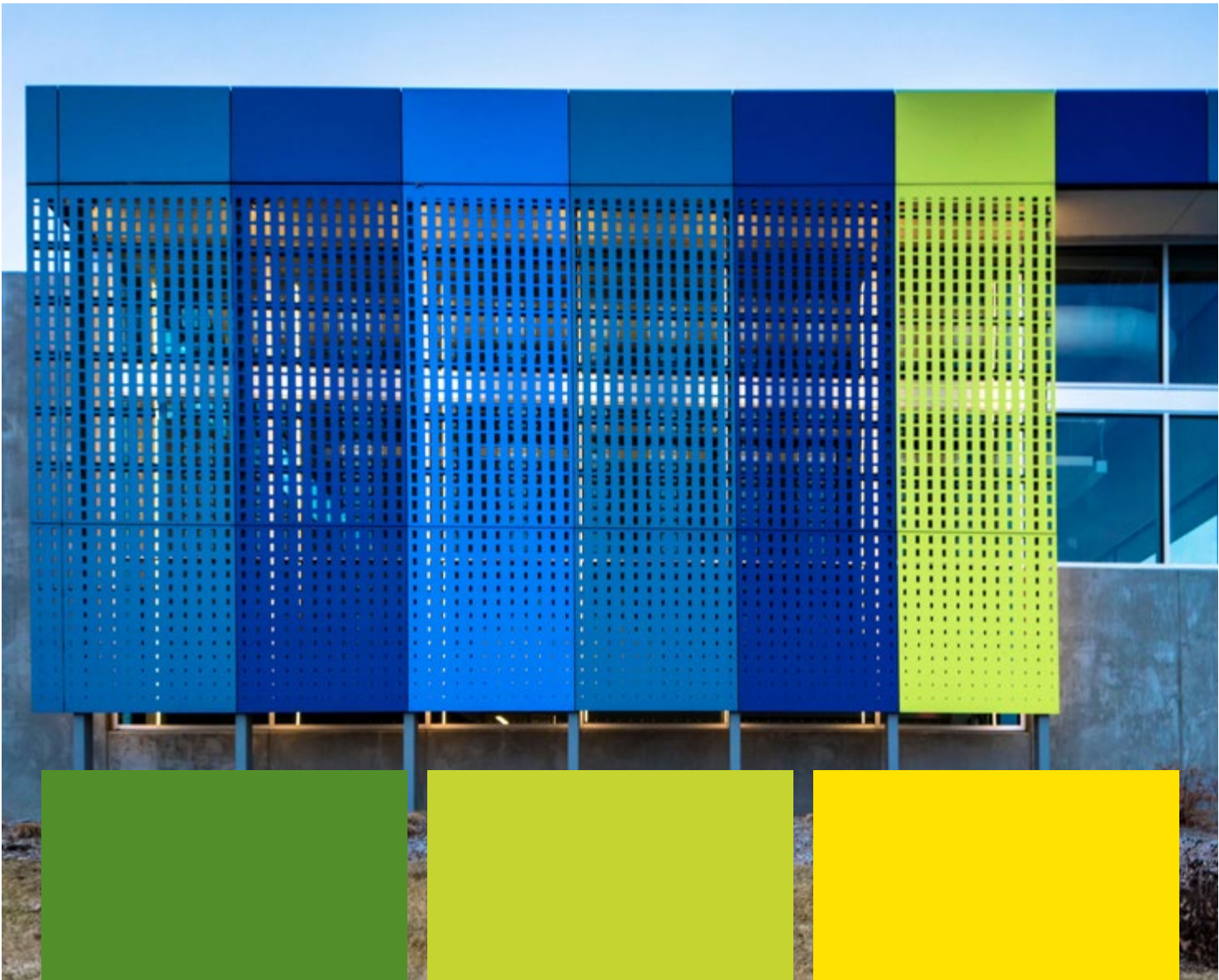

0850 Green Valley



0725 Yellowish Green

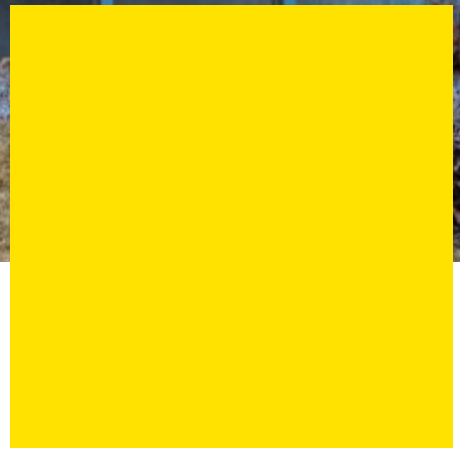

0865 Lemon



0237 Gentian Blue



0717 Atlantic



0674 Mars Red



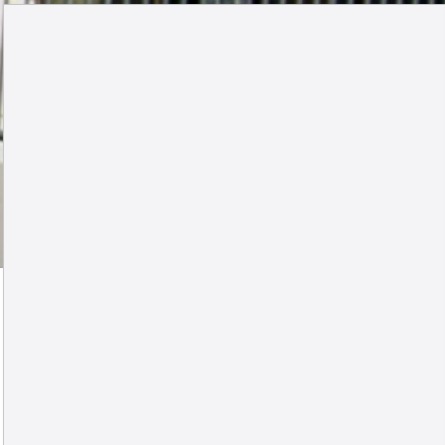

0091 Starlight

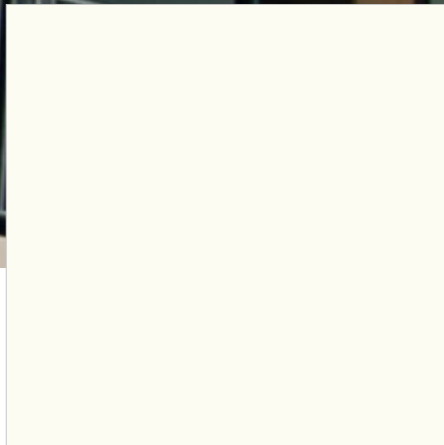

0085 White

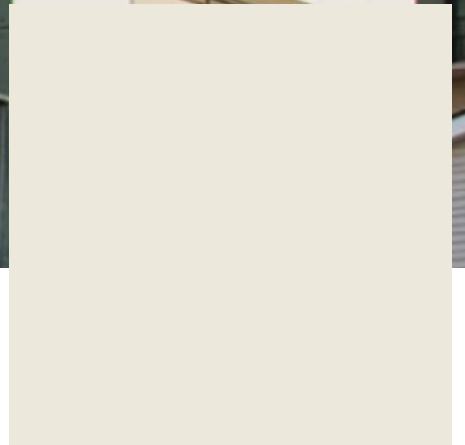

0742 Pebble Grey

Nature

Whatever people put together in terms of colour, shape, and texture, the world around us has already long since created it in one form or another. There is so much to discover, and most of it will be found in the smallest details.

In our Exterior Pro 2.3 | Surface Nature range, you'll find both bold and subtle wood textures and shades that don't just look really natural with the NP surface, they also feel incredibly pleasant to touch.

For you to create.



A close-up view of a dark brown wood grain with a rich, honey-like tone and prominent vertical grain patterns.

0870 Dark Honey Marvel Walnut

A close-up view of a medium brown wood grain with a caramel-like tone and vertical grain patterns.

0868 Caramel Marvel Walnut

A close-up view of a dark brown wood grain with a prominent vertical grain pattern and a slightly textured surface.

0909 Brown Flagship Oak

0907 Graphite Flagship Oak

0869 Smoked Marvel Walnut

0908 Grey Flagship Oak



Material

Witness the unyielding power of nature, strong accents, and smooth textures in natural harmony, moving within itself, constantly in motion. It's a fascinating interplay of texture, colour, and material.

In our Exterior 2.3 | Surface Material range, you'll find designs that reveal something new every time you look at your project.

For you to create.





0496 Colosseum



0421 Venus



0426 Loft



0394 Moonwalk



0861 Grey Eclipse Quartzstone



0497 Stonehenge

0793 Patina Tin

0406 Rockstar

0808 Desert Rose Sandstone

0799 Blackjack

0894 Black Pearl Concrete

0794 Patina Bronze



0898 Porto Nero Slate



0902 Black Stingray Limestone



0903 Urban Galaxy Limestone



0427 Skyline



0860 White Blizzard Quartzstone



0897 Grey Cliffhanger Slate



3 Decor overview and delivery programme

NG Gloss



NP Paragon

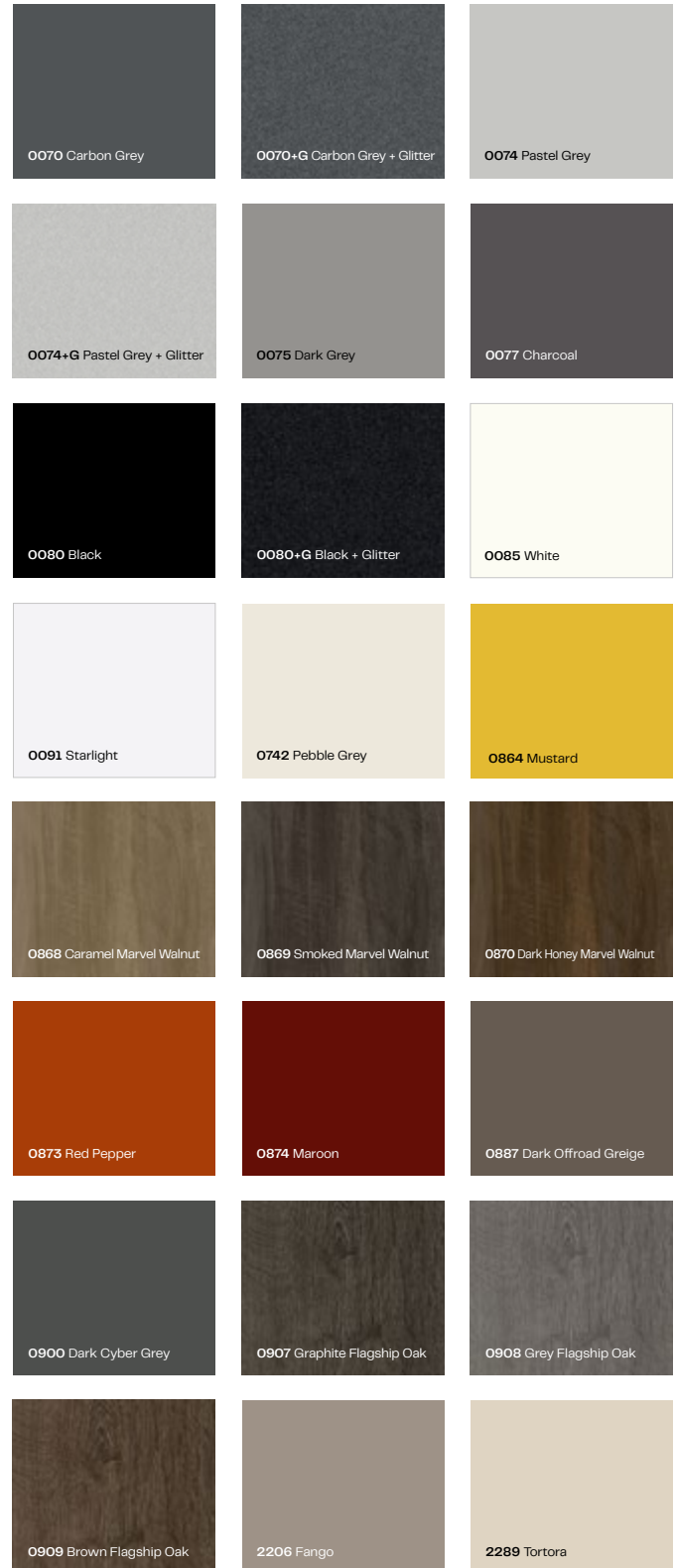

NY Sky



0070+G Carbon Grey + Glitter



0074+G Pastel Grey + Glitter

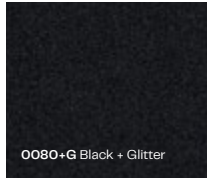

0080+G Black + Glitter

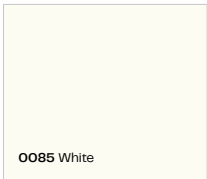

0085 White

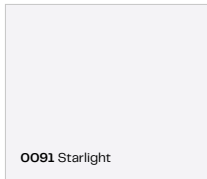

0091 Starlight



0394 Moonwalk

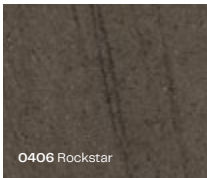

0406 Rockstar

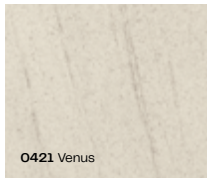

0421 Venus

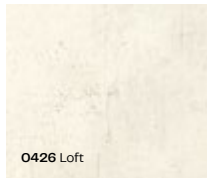

0426 Loft



0427 Skyline

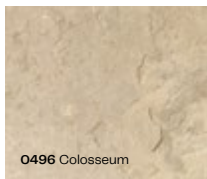

0496 Colosseum

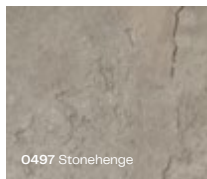

0497 Stonehenge



0742 Pebble Grey

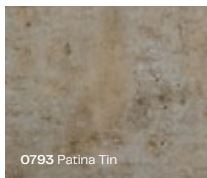

0793 Patina Tin

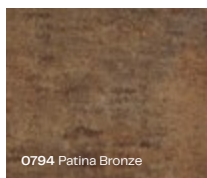

0794 Patina Bronze

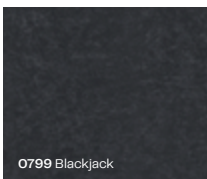

0799 Blackjack



0808 Desert Rose Sandstone

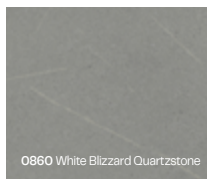

0860 White Blizzard Quartzstone



0861 Grey Eclipse Quartzstone

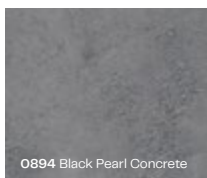

0894 Black Pearl Concrete



0897 Grey Cliffhanger Slate

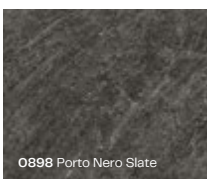

0898 Porto Nero Slate

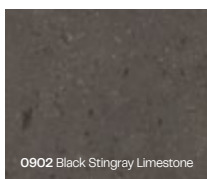

0902 Black Stingray Limestone

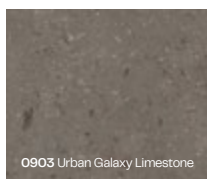

0903 Urban Galaxy Limestone



NG Gloss



NP Paragon



NY Sky

Exterior Pro 2.3 Surface (from April 2023)

		Collection	Exterior Pro 2.3 Surface			Decor on rear side ^{7/}	Decor direction	New for 2023	Compact Interior
		Quality	F						
		Format (mm)	4,100 x 1,300 mm	4,100 x 1,300 mm	4,100 x 1,300 mm				
		Thickness (mm)	6.0 8.0 10.0 12.0 13.0	6.0 8.0 10.0 12.0 13.0	6.0 8.0 10.0 12.0 13.0				
		Core	brown	brown	brown				
Decor type	Decor no.	Decor name	Nearest NCS code ¹⁾ / Species of wood	NG/NG ^{2,3,5}	NP/NT ^{2,4}	NY/NT ^{2,5}			
U	0070	Carbon Grey	S 7502-B	o	o		X	N	
S	0070 + G	Carbon Grey + Glitter		o	o	o	X	R	
U	0074	Pastel Grey	S 2500-N	o	o		X	N	☐
S	0074 + G	Pastel Grey + Glitter		o	o	o	X	R	
U	0075	Dark Grey	S 5000-N	o	o		X	N	☐
U	0077	Charcoal	S 7502-R	o	o		X	N	☐
U	0080	Black	S 9000-N	o	o		X	N	☐
S	0080 + G	Black + Glitter		o	o	o	X	R	
U	0085	White	S 0502-G50Y	o	o	o	X	N	☐
U	0091	Starlight	S 0502-R50B	o	o	o	X	N	
U	0237	Gentian Blue	S 5040-R80B	o			X	N	☐
M	0394	Moonwalk				o	X	L	
M	0406	Rockstar				o	X	L	
M	0421	Venus				o	X	L	
M	0426	Loft				o	X	L	
M	0427	Skyline				o	X	L	
M	0496	Colosseum				o	X	L	
M	0497	Stonehenge				o	X	L	
U	0674	Mars Red	S 1580-Y90R	o			X	N	
U	0717	Atlantic	S 2060-R90B	o			X	N	☐
U	0725	Yellowish Green	S 1060-G60Y	o			X	N	☐
U	0742	Pebble Grey	S 1002-Y	o	o	o	X	N	☐
M	0793	Patina Tin				o	X	L	
M	0794	Patina Bronze				o	X	L	☐
M	0799	Black Jack				o	X	L	
M	0808	Desert Rose Sandstone				o	X	L	☼
U	0850	Green Valley	S 4050-G30Y	o			X	N	☼
M	0860	White Blizzard Quartzstone				o	X	L	☼
M	0861	Grey Eclipse Quartzstone				o	X	L	☼
U	0864	Mustard	S 2060-Y10R	o	o		X	N	☼
U	0865	Lemon	S 0580-Y	o			X	N	☼
H	0868	Caramel Marvel Walnut	Walnut		o		X	L	☼
H	0869	Smoked Marvel Walnut	Walnut		o		X	L	☼
H	0870	Dark Honey Marvel Walnut	Walnut		o		X	L	☼
U	0873	Red Pepper	S 4550-Y70R	o	o		X	N	☼
U	0874	Maroon	S 7020-Y90R	o	o		X	N	☼
U	0887	Dark Offroad Greige	S 7005-Y20R	o	o		X	N	☼
M	0894	Black Pearl Concrete				o	X	R	☼
M	0897	Grey Cliffhanger Slate				o	X	R	☼
M	0898	Porto Nero Slate				o	X	R	☼
U	0900	Dark Cyber Grey	S 7500-N	o	o		X	N	☼
M	0902	Black Stingray Limestone				o	X	R	☼
M	0903	Urban Galaxy Limestone				o	X	R	☼
H	0907	Graphite Flagship Oak	Oak		o		X	L	☼
H	0908	Grey Flagship Oak	Oak		o		X	L	☼
H	0909	Brown Flagship Oak	Oak		o		X	L	☼
U	2206	Fango	S 4005-Y50R	o	o		X	N	☼ ☐
U	2289	Tortora	S 1505-Y40R	o	o		X	N	☼ ☐

Decor types

U = Colour
 H = Nature
 M = Material
 S = Specials

Surfaces

NG = Gloss
 NY = Sky
 NP = Paragon

Decor/Decor direction

L = This decor goes in a lengthwise direction.
 (Please take into consideration when arranging and cutting.)
 N = This decor doesn't have a direction. It can be turned when cutting.
 (Not the case for NP surfaces. Please take into consideration the further notes on NP.)
 R = This decor goes in a crosswise direction.
 (Please take into consideration when arranging and cutting.)
 X = Decor on both sides

Delivery options

o = according to current delivery times
 [] = Decor also available as Compact Interior. For details, see the Compact Interior delivery programme.
)3 = All Colour NG decors are also available as Metallic (Dualis Overlay Glitter).
)7 = Exterior surfaces NT, NG, and NH can also be supplied with O890 Balkonweiss on the reverse side.
 Protective film = Surfaces NG and NP are supplied with protective film. The NY surface is always supplied without protective film.

Notes

)1 = Details on RAL and CMYK colour systems can be found on our website: www.fundermax.com
)2 = Front side/reverse side surfaces: NG: NG/NG | NP: NP/NT | NY: NY/ NT | NH: NH/NT (NY and NH are supplied with NT on the top).
)4 = NP surface: be sure to follow the same direction when installing. (Turning by 90° or 180° can lead to visual differences)
)5 = Additional surfaces and decors combinations can be found at www.fundermax.com
 F = Max Compact Exterior F Quality. For details on fire classes and approvals, see TI Exterior.
 ✨ = New decor for 2023

4 Products

Everything Max Compact Exterior can do

Max Compact Exterior panels are thermoset high-pressure laminates (HPL) that meet the requirements of EN 438-6, type EDF, and are produced in high-pressure lamination presses at high temperature.

Dual-cure acrylic polyurethane resin ensures highly effective weather protection, making it particularly well suited to balcony and facade cladding.

For extreme weather and environmental conditions*



highly
weather-resistant



optimally lightfast

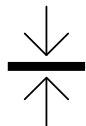

dual-cure



scratch-resistant



impact-resistant

Design freedom and efficiency



Large range of
decorative finishes



Design using CNC
systems



Cost savings—5 sizes,
little waste

Installation and Maintenance



Quick installation

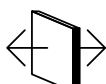

Decor on both sides



Easy to clean



Resistant to solvents

Composition of Max Compact Exterior Panels

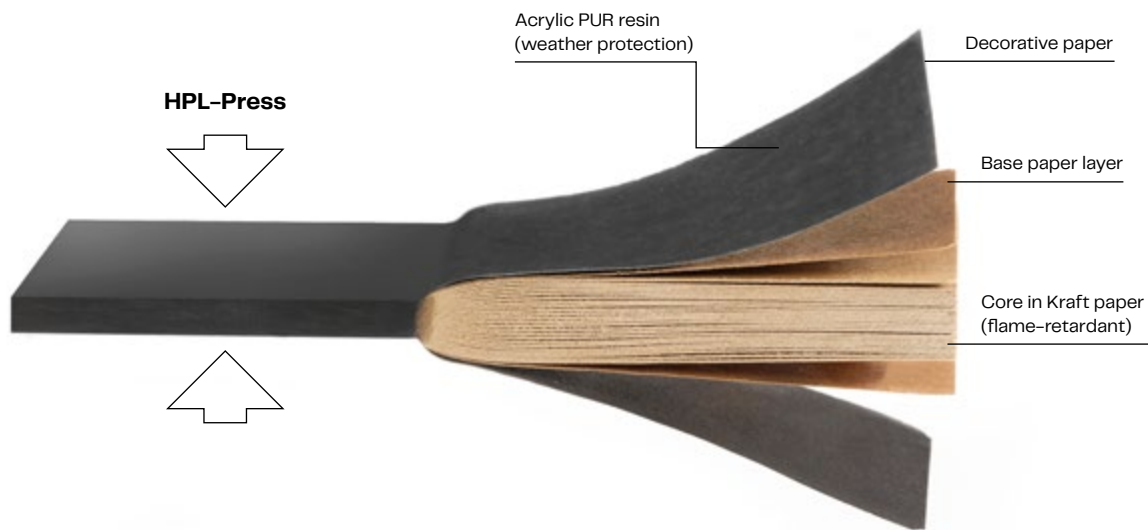

The 'Biobased Product' label highlights biobased materials that contain a significant proportion of biomass by certifying their content of biobased materials.

A minimum proportion of biobased material is defined for each product family (60% for facade cladding).



FSC certification guarantees the origin and traceability of timber and paper products with a minimum amount of timber.

Certified products come from sustainable, socially responsible, and economically viable forestry management along the entire supply chain.



PEFC certification guarantees the origin and traceability of timber and paper products with an obligation for improvement.

Certified products come from sustainable forestry management that respects biodiversity and the vitality of ecosystems.

Max Compact Exterior F Quality

A high-quality construction product bearing the CE label for use as durable balcony and facade cladding. The panels are thermoset high-pressure laminates (HPL) that meet the requirements of EN 438-6, type EDF, with the most effective weather protection thanks to dual-cure acrylic polyurethane resin.

Exterior Pro 2.3 Surface

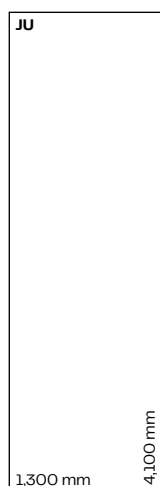

Surfaces*

- NG (Gloss) on both sides
- NP (Paragon), NT on reverse side
- NY (Sky), NT on reverse side

Size**

- 4,100 x 1,300 mm = 5.33 m²

Thicknesses

Panels with decor on both sides:

Thickness	Tolerance (EN 438-6, 5.3)
• 6.0 mm	± 0.3 mm
• 8.0, 10.0 mm	± 0.5 mm
• 12.0, 13.0 mm	± 0.6 mm

Core

- F Quality
- (flame retardant)
- Brown colour

* For the best possible appearance of the facade cladding, installation on an aluminum subframe is recommended. Timber is advised against, as an uneven surface can lead to a wavy appearance.

** Panel sizes with tolerances of +10-0 mm (EN 438-6, 5.3) are standard sizes—if absolute size and angle precision is required, cutting around all sides is recommended. Depending on the cut, the net measurement reduces by approx. 10 mm.

Options

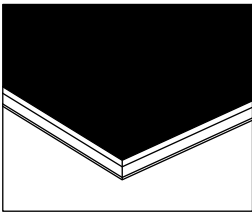

Max Compact Exterior F Quality

Max Compact Exterior panels are supplied with decors on both sides as standard. The core is made to be flame-retardant, the surface is lightfast, and the dual-cure resin is extremely weather-resistant.
(Fire Test EN 13501-1, B-s2, d0)

Max Compact Elements

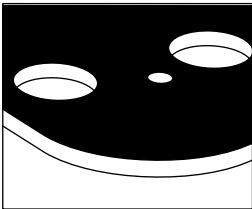

Machining Service

Fundermax offers the option of cutting the panels and CNC machining. Using state-of-the-art systems, virtually all requirements can be fulfilled, from simple hole drilling for mounting facade panels to intricate machining for balcony components.

Consultation

Make the most of our architect consultation service and the extensive track record of our application technology. Certifications, approvals, BIM objects, and technical information can be found in the Downloads section on our website. Materials and decorative samples can be ordered from our website around the clock.

Tip

For a consistently light design for the interior of balconies, Max Compact Exterior panels can also be made with a white (reverse) side (0890 NT – Balkonweiss). The combination of different decors means the stated fixing distances should be reduced by at least 15%.



Max Compact Exterior—physical data and approvals

Properties	Testing method	Assessment	Standard value ¹⁾	Typical value ²⁾
Lightfastness and weather resistance (NT)				
Resistance to artificial weathering*	EN 438-2:2016, Section 29, 3000 h	Contrast: Gray scale Appearance: Degree	Contrast: ≥ 3 Appearance: ≥ 4	Contrast: 4–5 Appearance: 5
Resistance to UV rays*	EN 438-2:2016, Section 28	Contrast: Gray scale Appearance: Degree	Contrast: ≥ 3 Appearance: ≥ 4	Contrast: 4–5 Appearance: 5
Properties	Testing method	Unit of measurement	Standard value ¹⁾	Typical value ²⁾
Mechanical properties				
Bulk density	DIN 52328 / EN ISO 1183	g/cm ³	≈ 1.35	1.44
Flexural strength	EN ISO 178	MPa	≈ 80	Crosswise: 105 Lengthwise: 170
Flexural modulus	EN ISO 178	MPa	$\approx 9,000$	Crosswise: 11,000 Lengthwise: 16,000
Tensile strength	EN ISO 527-2	MPa	–	Crosswise: 95 Lengthwise: 140
Resistance to impact with a large ball	EN 438-2:2016, Section 21	mm	≤ 10	5–6
Thermal properties				
Resistance to moisture	EN 438-2:2016, Section 15	%	Mass increase ≤ 8	2
Dimensional tolerance at high temperature	EN 438-2:2016, Section 17	%	Lengthwise: ≤ 0.30 Crosswise: ≤ 0.60	Lengthwise: 0.08 Crosswise: 0.16
Coefficient of thermal expansion	DIN 52328	1/K		18 x 10 ⁻⁶
Thermal conductivity		W/mK		0.3
Water vapor diffusion resistance				approx. 17,200 μ
Building material classes				
Europe building material class	EN 13501-1	MA39-VFA Vienna	Euroclass B-s2, d0 for 6–13 mm**	
Austria facade fire testing	ÖNORM B 3800-5	MA39-VFA Vienna	tested panel thicknesses 8–13 mm	
Switzerland building material class	EN 13501-1	MA39-VFA Vienna	Euroclass B-s2, d0 for 6–13 mm ²⁾	
France building material class	NFP 92501	LNE	M1 for 2–10 mm	
Spain building material class	UNE 23727-90	LICOF	M1 for 6–10 mm	
Approvals				
Germany facade approval		Deutsches Institut für Bautechnik, Berlin	6, 8, 10 mm, Approval no. Z-10.3-712	
ETB guidelines for components that protect against falling, from 6/1985 balcony railings		TU Hanover	present (depending on building regulations and railing construction, 6, 8, 10, or 13 mm panel thickness)	
France Avis technique		CSTB	6, 8, 10, and 13 mm, timber and metal subframe, approval No. 36-87 2/16-1749 No. 36-106 2/2/14-1623_V1 No. 36-125 2/2/13-1565_V2 No. 36-125 2/2/21-1809_V1 No. 36-125 2/2/16-1716 No. 36-29 ATT-20/013_V1 No. 26-29 ATT-20/014_V1	
WinMark UK		Wintech	A10114	

For the NT surface, a gloss level tolerance of ± 5 GE is measured at 60°. With regard to colour tolerance, the ÖFHF (www.oefhf.at) Tolerances data sheet dated 16 January 2017 applies.

1) In accordance with EN 438-6

2) Typical values are given as an example only and may not be consulted in the case of any possible liability of Fundermax (they are not confirmed, guaranteed values). Fundermax only guarantees compliance with standard values.

* Custom decorative printing: artificial weathering EN ISO 4892-2: 3,000 h; Assessed based on the gray scale EN 20105-A02: 3

** The exception is the Podio balcony flooring panel, Euroclass B-s2,d0 (6–20 mm)

Other and up-to-date tests and approvals can be found in the Downloads section on www.fundermax.com.

Please take into account any currently valid building regulations; we accept no liability in this regard.

Please check whether your construction project complies with the requirements to effectively restrict the spread of fire (e.g., Austria: OIB RL 2, Germany: Model Administrative Provisions – Technical Building Rules, MVV TB, etc.)

This brochure is intended for specialists who are trusted to adhere to the relevant standards, technical regulations, legal requirements, and relevant guidelines relating to building products. Rules have been painstakingly revised, however, we would like to point out that responsibility for proper planning always lies with the planner, and responsibility for correct installation lies with the contractor.

5 Fundermax Individual Solutions

Application technology

Fundermax has been producing compact panels in Austria for over 50 years. During this time, we've advised and worked with business partners on countless projects. We collaborate with all major system partners in the field of ventilated facades and balconies, and in doing so are constantly expanding our knowledge, which we're then happy to put into the planning and realization of your project. Our experts in the area of building approval and certification deal with ensuring all relevant certifications are up to date and new ones are added. Furthermore, through our in-house services for cutting and CNC machining, we have links with all prominent tool suppliers so that we can give you the best possible advice when it comes to machining.

Application technology services



Handling
compact panels

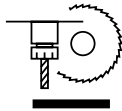

Machining compact
panels

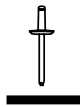

Mounting options for
compact panels

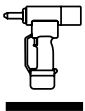

Installation of
compact panels



Certifications and
approvals



BIM objects and
CAD details



Support and
email contact

For you to create—Maximum design possibilities with Fundermax Exterior

Facades are a critical architectural element, giving a building its symbolic expression and conveying the intention of the architect. At the same time, they serve as a backdrop for the public space and urban life.

With its huge range of highly weather-resistant and optimally lightfast colours, decors, and surfaces, the Fundermax Exterior collection allows for an extremely broad spectrum of design possibilities. Fundermax custom printing offers maximum design freedom, as well as the option of choosing any shape and machined engraving, which can be designed using modern CNC systems.



Design freedom for facade layout and surface design

Thanks to modern CNC systems, it is possible to design creative facade layouts and add accents using machined engraving. Fundermax Exterior panels are uniform in their composition, so sealing the edges isn't required.

Make use of our decades of experience in the machining of compact panels and order your project so that it's pre-sorted and ready for installation.

Compact Elements by Fundermax services



Pre-sorted and labeled according to construction phase

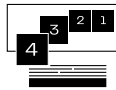

Pre-sorted, labeled, and palletized ready for installation



CNC surface design

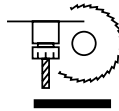

Machining compact panels

Advantages

- No personal risk when cutting
- Precision machining results
- Can be delivered without offcuts on request, reducing workload when closing down the construction site
- Numbering, palletizing, and sorting in preparation for installation makes construction site logistics easier and saves space



5 02



5 03

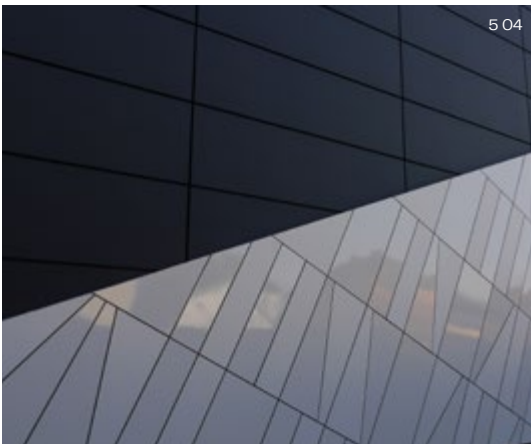

5 04



5 05

- 5 02** Facade layout
Project: Aquapark
- 5 03** Facade layout
Project: Construction of School
- 5 04** Facade layout
Project: Eurospar St. Valentin
- 5 05** Facade layout
Project: Veganista



5 06



5 07

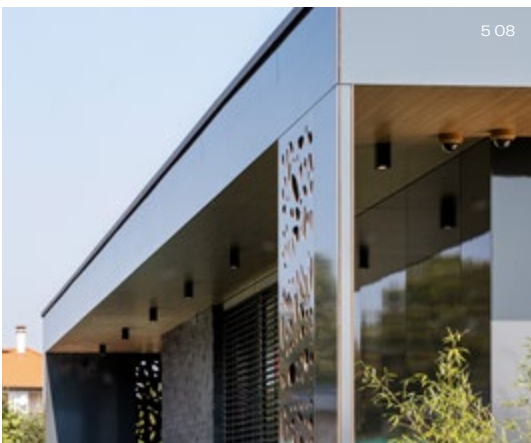

5 08



5 09

- 5 06** Openings and engraving
Project: Cinema
- 5 07** Openings and engraving
Project: McDonald's Batumi
- 5 08** Openings and engraving
Project: Detached house
- 5 09** Openings and engraving
Project: Music school

6 Essential collection

Exterior 2.3 Essential

Exterior 2.3 | Essential offers maximum choice of decors and maximum efficiency with the NT surface, which offers a silky matte effect. As a result, the appearance achieves a certain shimmer that, regardless of the light conditions and specific application, provides plenty of character. The fine hammered texture complements this appearance to create an overall image of accomplished beauty.

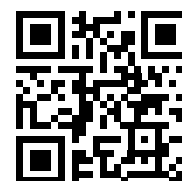

Exterior 2.3 | Essential





Exterior Pro 2.2 Podio

Weatherproof, slip-resistant and scratch-resistant, these are just a few criteria that our specially developed balcony panel Max Compact Exterior Podio with Hexa surface meets. Due to the easy installation by screwing or gluing as well as the slip resistance according to R10 DIN 51130 and DIN 51097 it is perfectly suitable for balconies, stairs and landings. Because of the selection of different decors, the plate leaves nothing to be desired.



Exterior Pro 2.2 | Podio



Exterior Pro 2.2 Authentic

Each decor of the Authentic Collection is available in three surface finishes:

- NT
- NY
- NH



Exterior Pro 2.2 | Authentic

Lovers of brown and natural tones can now enjoy three completely new decors, all part of the Authentic Natura (AUTN) family.

Authentic Mocca

Sometimes stronger, milder, darker, lighter—all in all, Authentic Mocca is a more than tasteful composition.



AU01 Authentic Mocca



Authentic Pecan

With pecans, the treasured content is protected by a resistant shell. The same is true of a building's interior and facade. By using "Authentic Pecan" an aesthetically pleasing look can be achieved.



AU02 Authentic Pecan



Authentic Caramel

Facades in a "salted caramel look" range from golden yellow to honey brown. This decor was inspired by the widely loved caramel candy with its different shades of colour.



AU03 Authentic Caramel



Fundermax Deutschland GmbH

Mundenheimer Weg 2
67117 Limburgerhof, Germany
info@fundermax.biz
www.fundermax.com

Fundermax France S.a.r.l.

3 Cours Albert Thomas
69003 Lyon, France
T +33 (0)4 78 68 28 31
infofrance@fundermax.biz
www.fundermax.com

Fundermax India Pvt. Ltd.

Sy. No. 7, Honnenahalli, Doddballapur Road,
Yelahanka Hobli, Bangalore – 560064, India
T +96113 99211
officeindia@fundermax.biz
www.fundermax.in

Fundermax Italia s.r.l.

Viale Venezia 22
33052 Cervignano del Friuli, Italy
infoitaly@fundermax.biz
www.fundermax.com

Fundermax North America, Inc.

9401-P Southern Pine Blvd.
Charlotte, NC 28273, U.S.
T +1 980 299 0035
office.america@fundermax.biz
www.fundermax.us

Fundermax Polska Sp. z o.o.

ul. Rybitwy 12
30-722 Kraków, Poland
T +48 (0)12 65 34 528
infopoland@fundermax.biz

Fundermax Swiss AG

Industriestrasse 38
5314 Kleindöttingen, Switzerland
T +41 (0)56 268 83 11
infoswiss@fundermax.biz
www.fundermax.com

4/23-PR.103.ENWEB

Fundermax GmbH

Klagenfurter Straße 87–89, 9300 St. Veit/Glan, Austria
T: +43 (0)5 9494–0, F: +43 (0)5 9494–4200
office@fundermax.at
www.fundermax.com

MEMBER OF *Constantia* INDUSTRIES

Legal notice:
Fundermax GmbH, 9300 St. Veit/Glan, Austria
Producer: Print Alliance, 2540 Bad Vöslau, Austria

